



POWER ASSIST WHEELBARROW OWNER'S MANUAL

44322 & 44321



#44322
Includes frame,
tires and tub

#44321
Includes frame
and tires

Max load 350 lbs.

Customer service: 651.370.7508

Monday – Friday 8am – 5pm CST
chorewarrior.com

Power Assist Technologies
926 Dale St N
St. Paul, MN 55103

TABLE OF CONTENTS

Congratulations on your purchase.....	1	Attaching the tray brace / adding oil.....	1
Safety instructions.....	2	Attaching a tray.....	1
Battery and tire care.....	3	Charging the batteries.....	1
Parts inventory.....	4	Operating your Chore Warrior.....	14-25
Drive system assembly.....	5	Loose wiring / 12 volt battery removal.....	15
Attaching the tires.....	6	Maintenance.....	35
Assembling main frame to drive system.....	7	Troubleshooting.....	16
Attaching handles and electronics box.....	8	Warranty / product registration.....	17
Attaching the battery box.....	9	Contact info.....	18
Attaching / adjusting wiring.....	10		

CONGRATULATIONS

THANK YOU
FOR PURCHASING YOUR NEW CHORE WARRIOR
MODEL #44322

We have designed and built your new Chore Warrior with the goal of making your life easier. The Chore Warrior works great for many applications.

PLEASE READ AND UNDERSTAND THE FOLLOWING CAUTIONS, SUGGESTIONS AND WARNINGS TO HELP ENSURE THE SAFE OPERATION OF YOUR CHORE WARRIOR.

ALWAYS KEEP IN MIND Your Chore Warrior is a piece of power equipment and needs to be used with the care and caution required of all power equipment and tools. Never let an adult, child or pet ride in your Chore Warrior due to the risk of possible harm or injury. Avoid operating in the close proximity of adults, children, pets or objects. Keeping a safe distance is the best way to avoid possible harm or injury. Collisions with objects can result in damage to the object and/or your Chore Warrior. Under no circumstances allow young children 16 years of age or younger to operate the Chore Warrior. Youth 16-18 years of age should ONLY be allowed to use the Chore Warrior with adult supervision. Failure to use caution while operating the Chore Warrior could cause injury to others and damage to property. Always turn the power switch to the OFF (0) position when Chore Warrior is not in use.

If you have any questions, please contact customer support at
1-651-370-7508 or at www.chorewarrior.com

SAFETY INSTRUCTIONS

Carefully read, understand and follow all safety instructions in this manual.



This is the safety alert symbol. When you see this symbol, look for one of the following signal words:

DANGER

DANGER indicates a hazardous situation which, if not avoided, will result in death or serious injury.

WARNING

WARNING indicates a hazardous situation which, if not avoided, could result in death or serious injury.

CAUTION

CAUTION used with the safety alert symbol, indicates a hazardous situation which, if not avoided, could result in minor or moderate injury

NOTICE

NOTICE is used to address practices not related to personal injury.

Read these warnings carefully. Know the application and limitations of the Chore Warrior. Failure to follow these warnings could result in serious bodily injury and/or property damage.

DANGER

- NEVER allow people, children or pets to ride in your Chore Warrior. Doing so can cause injury or harm to them.
- NEVER modify the electrical system. Alterations may cause serious injury and could ruin or permanently damage the components. Use of your Chore Warrior components in any other products or applications could cause overheating, fire or explosion resulting in harm, damage or injury to others or property.
- Chore Warrior should NEVER be immersed in water. Immersing the drive system or electrical components can cause operational failure of your Chore Warrior and possible electrical shock.
- NEVER use any components other than those supplied with Your Chore Warrior to charge the batteries. Use of other cables, chargers or any non-approved electrical equipment can cause electrical shock & fire resulting in possible harm and/or serious personal injury to you or others.
- ONLY USE AGM sealed type batteries. Non -sealed batteries can leak battery acid causing damage to property and harm to people or pets.

WARNING

- NEVER allow children to charge the battery. Battery charging must be done by adults only. A child could be injured by the electricity involved in charging the battery.
- The battery must be handled by adults only. The battery is heavy and contains sulfuric acid (electrolyte). Dropping the battery could result in an acid leak and result in serious personal injury. If skin contact is made with battery acid, wash immediately with soap and water. If irritation continues seek medical attention.
- NEVER operate your Chore Warrior in an overloaded condition. Stacking material above the tray rim or over the sides of the tray can cause the Chore Warrior to be uncontrollably out of balance resulting in harm or injury to you or others, and damage to property.
- NEVER operate your Chore Warrior in an overweight condition, 350 lbs. max. weight capacity. Weight capacity can also be limited by physical capability of the operator. Most healthy adults can operate the Chore Warrior safely with loads of up to 100 pounds. Operating with loads above 100 pounds is a personal decision and only you can judge your capability. Under no circumstances should you attempt to move a load weighing over 350 lbs.
- NEVER touch the drive motor or axles after prolonged Chore Warrior use. It is normal for the drive components to get warm to the touch, even hot, after prolonged use.
- NEVER operate your Chore Warrior or allow others to operate it while under the influence of drugs or alcohol.

CAUTION

- NEVER under any circumstance tow the Chore Warrior behind a vehicle.
- NEVER operate your Chore Warrior without having both hands firmly grasping the handles. Failure to do this can cause loss of control, resulting in harm or injury to others and possible damage to property.
- NEVER operate your Chore Warrior at speeds faster than a walk. (3 miles per hour.) The tires are only designed for low speed use. Using your Chore Warrior at higher speeds may result in tire failure or blowouts and could cause injury to others and damage to property.
- Your Chore Warrior is designed for outdoor use. Indoor use may cause damage to flooring or other household items.

NOTICE

- The Chore Warrior is water resistant, not waterproof. During snowy or rainy weather, your Chore Warrior should be stored inside or under a protective cover.

BATTERY & TIRE CARE

CHORE WARRIOR BATTERIES

It is recommended to fully charge your batteries installed in your Chore Warrior before each use. Always charge the batteries in the upright position. For best results, charge the batteries while installed in your Chore Warrior. When in storage keep the battery box and/or Chore Warrior in a "parked" position with the drive wheels and both support legs flat on level ground.

Cold weather storage: For prolonged storage in below freezing temperatures it is recommended to unplug and remove the battery box from the chassis. During long winter storage it is recommended to periodically recharge the batteries using the charger to ensure longer life.

Your Chore Warrior comes with (2) 12 volt high-quality, safety sealed, AGM type batteries. Like all batteries they contain battery acid. Your batteries meet the AGM safety standard. This means they have extra protection to ensure they stay sealed. However, if they are dropped or misused may crack or break allowing for an acid leak. Inspect your batteries regularly to ensure there is no sign of acid leak.

DANGER

- NEVER charge your Chore Warrior in a wet or moist environment or while Chore Warrior is in contact with water.

WARNING

- If acid comes in contact with skin or eyes, flush immediately with water for at least 15 minutes. If irritation persists call a physician.
- If acid is internally ingested, give water, milk of magnesia or egg whites immediately. Never give emetics or induce vomiting. Seek professional medical help immediately.
- If a battery leak develops, avoid contact with the leaking acid and place the damaged battery in a plastic bag. See "Battery Disposal" for proper disposal.

CAUTION

Before charging the battery, examine the battery case for cracks and other damage which may cause sulfuric acid (electrolyte) to leak during the charging process. If damage is detected, do not charge the battery or use it in your Chore Warrior. Battery acid is very corrosive and can cause severe damage to surfaces it contacts. Using acid resistant gloves, put the leaking battery in a heavy plastic bag and dispose in accordance with local regulations. It is unlawful to dispose of your batteries in normal municipal trash services. Batteries must be taken to an authorized battery return operations. Most retail outlets that sell batteries are required to take all batteries for disposal. Or check with your local municipality for the disposal location nearest you for instructions on proper disposal.

NOTICE

- Battery must be upright while charging. If power flow to the wall outlet is controlled by a switch, make sure the switch is on. Use the charger only in a wall outlet (use of a GFCI outlet is recommended).
- Do not place the battery on a surface (such as kitchen counter tops) which could be damaged by the acid contained inside the battery. Take precautions to protect the surface on which you place your battery.
- The battery charger is not a maintainer and should not be plugged into the battery pack for longer than 24 hours. Leaving the charger connected can over-charge the batteries and shorten the battery life.

BATTERY DISPOSAL:

Your battery is a non-spillable, sealed lead-acid battery. It must be recycled or disposed of in an environmentally sound manner. Do not dispose of a lead-acid battery in a fire as the battery may explode or leak. Do not dispose of a lead-acid battery in your regular household trash. The incineration, landfilling or mixing of sealed lead-acid batteries with household trash is prohibited by law in most areas. Return an exhausted battery to a federal or state approved lead-acid battery recycler, such as a Chore Warrior authorized dealer or seller of automotive batteries. Contact your local waste management officials for other information regarding the environmentally sound collection, recycling and disposal of lead-acid batteries. In most states it is prohibited by law for anyone to throw away lead-acid batteries in the municipal waste stream. Check with your state for specific rules and regulations.

PROPER TIRE CARE

WARNING

- Improper tire pressure may cause unstable operation and can result in a tire blowout and/or loss of control. Therefore, **check the tire pressure before each use.** Improperly inflated tires cause tires to wear out prematurely and may result in loss of control resulting in harm or injury to yourself and others.

Your Chore Warrior tires are only designed for low speed use. Optimum and maximum operating air pressure is 30 pounds per square inch (PSI). Your tires come pre-inflated from the factory. It is a good idea to check the initial pressure to ensure the proper 30 PSI pressure required. Do not over-inflate your tires. Over-inflation can result in tire/rim failure and/or possible tire explosion that may cause harm and injury to you, others and damage to property.

Your tires have treads to help it maintain traction and stability. It is essential to inspect the tires before each use. If a tire is cracked, has a bald spot, bulge, cuts, any cords showing, or has uneven tread wear, replace the tire with a Chore Warrior approved tire before further use. Tires with damage or with too little tread will not provide adequate traction which could result in loss of control, possibly leading to serious injury.

PARTS INVENTORY

● = LEFT ● = RIGHT

Tools Required for Assembly

- 27mm or 1 1/16" socket/wrench
- 16mm or 5/8" socket/wrench
- 13mm or 1/2" deep socket/wrench both ratchet and extension
- 12mm socket/wrench
- 10mm socket/wrench
- 6mm Allen wrench

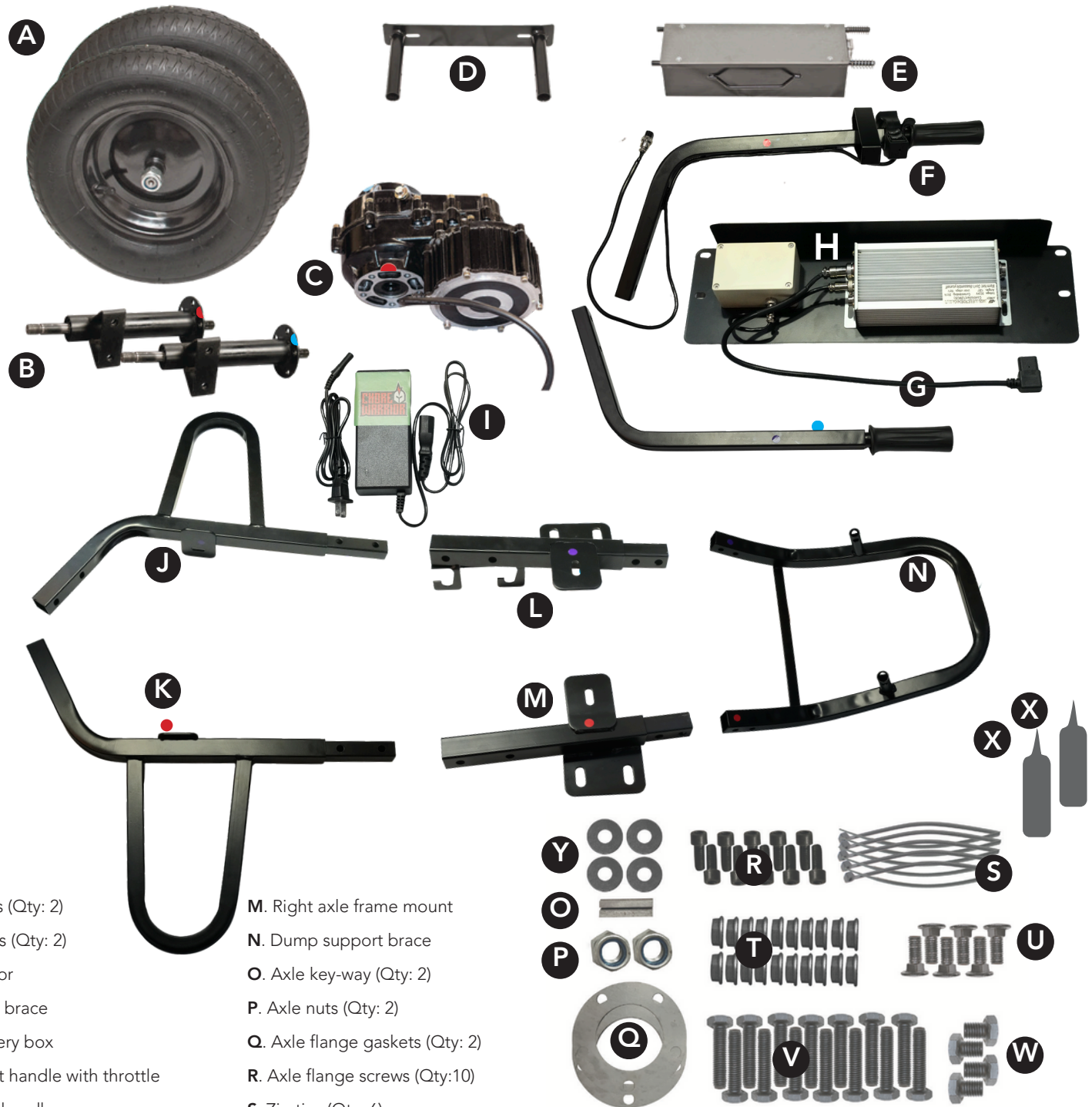

- A. Tires (Qty: 2)
- B. Axles (Qty: 2)
- C. Motor
- D. Tray brace
- E. Battery box
- F. Right handle with throttle
- G. Left handle
- H. Electronics box
- I. Battery charger
- J. Left support leg
- K. Right support leg
- L. Left axle frame mount

- M. Right axle frame mount
- N. Dump support brace
- O. Axle key-way (Qty: 2)
- P. Axle nuts (Qty: 2)
- Q. Axle flange gaskets (Qty: 2)
- R. Axle flange screws (Qty: 10)
- S. Zip ties (Qty: 6)
- T. M8 hex nuts (Qty: 20)
- U. M8 x 25mm carriage bolts (Qty: 2)
- V. M8 x 40mm hex bolts (Qty: 14)
- W. M10 x 20mm hex bolts (Qty: 4)
- X. Motor oil (Qty: 2)

ITEM #s:

- A. 44257
- B. L. 44345
- R. 44344
- C. 44342
- D. 44319

- E. 44362
- F. 44312
- G. 44311
- H. 44329
- I. 44375
- J. 44317
- K. 44318

- L. 44339
- M. 44340
- N. 44316
- O-W hardware pack: 44387
- X. 44359
- Y. Washers

DRIVE SYSTEM ASSEMBLY

1. Attach left and right axles (B) to motor using axle flange gaskets (Q) and axle flange screws (R). Tighten hardware using a 6mm Allen wrench.

NOTE: red dots (right) and blue dots (left) should line up as shown. You may have to wiggle the axle a bit to "marry" the grooves and line up the screw holes correctly.

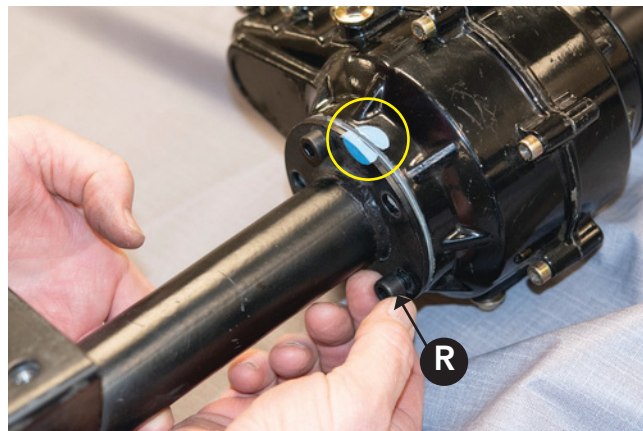
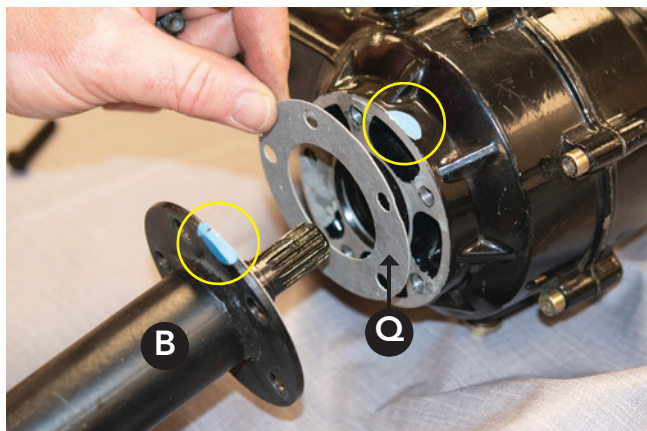

2. Attach left (L) and right (M) axle frame mounts to corresponding axles as shown using M10 x 20mm hex bolts (W) and washers (Y). Hand tighten hardware.

NOTE: single tab side of each axle frame mount should face towards motor.

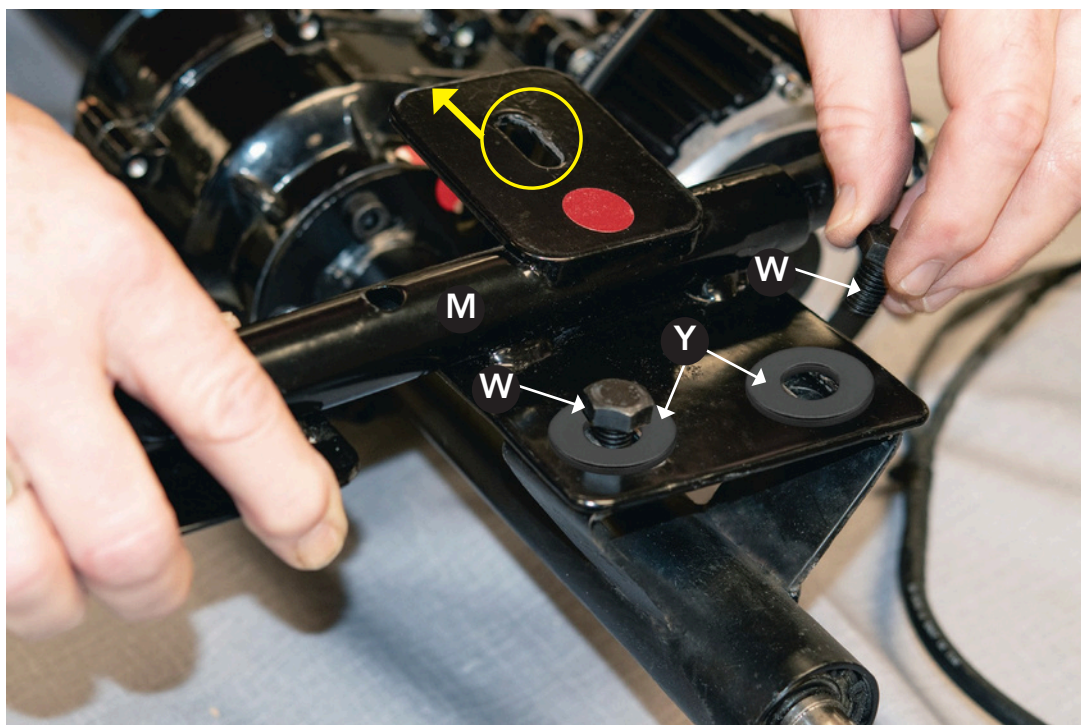

ATTACHING TIRES

1. Place axle key-ways (O) into grooves of each axle as shown.

NOTE: Air fill valve on rim of tires should be facing out (opposite side from the motor).

2. Slide tires onto axles, taking care to match up the notch in the wheel with the key-way on the axle.



3. Screw on the locking axle nuts (P).



ATTACHING MAIN FRAME TO DRIVE SYSTEM

1. Slide the dump support brace (N) onto the assembled axle frame mounts. Secure with M8 x 40mm hex bolts (V) and hex nuts (T).

IMPORTANT!

Hand tighten only.

From this part of the manual and on, only tighten hardware by hand until Chore Warrior is fully assembled; then use tools to tighten all hardware.

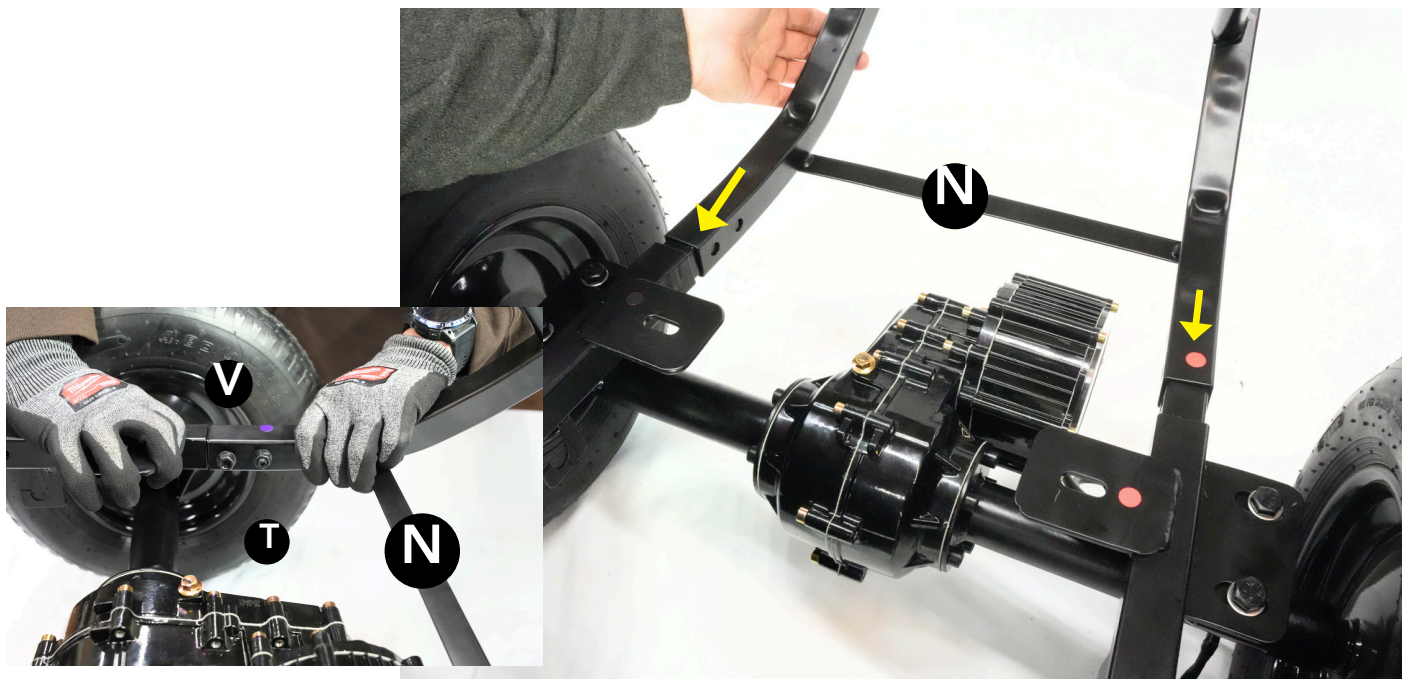

2. Attach right (K) and left (J) legs to the other side of the assembled axle frame mounts. Secure with M8 x 40mm hex bolts (V) and hex nuts (T).

NOTE: make sure tabs are facing inwards as shown.



Now your Chore Warrior should look like this:

ATTACHING HANDLES AND ELECTRONICS BOX

1. Insert left handle (G) into assembled frame as shown. Be sure to line up screw holes. Secure with M8 x 40mm hex bolts (V) and hex nuts ((T)).
2. Insert the right handle (F) into the frame as shown and secure with M8 x 40mm hex bolts (V) and hex nuts (T).



3. Attach electronics box (H) to left handle using M8 x 40mm hex bolts (V) and hex nuts (T).



4. Attach the right side of electronics box to right handle as shown using M8 x 40mm hex bolts (V) and hex nuts ((T)).

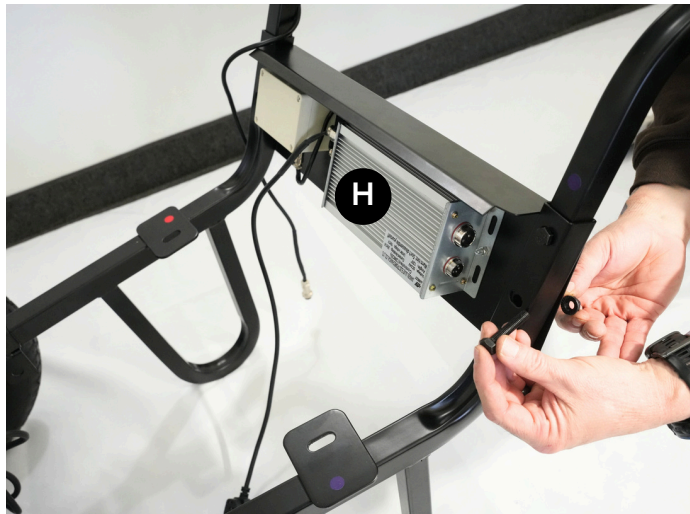

5. Match up wires to their ports and plug in; twist threaded couplers to secure.



Your handles and electronics box should look like this when assembled:



ATTACHING BATTERY BOX

1. Position battery box (E) so the handle is facing away from the motor. Insert (springs side first) into the right side battery mount holes on the frame.

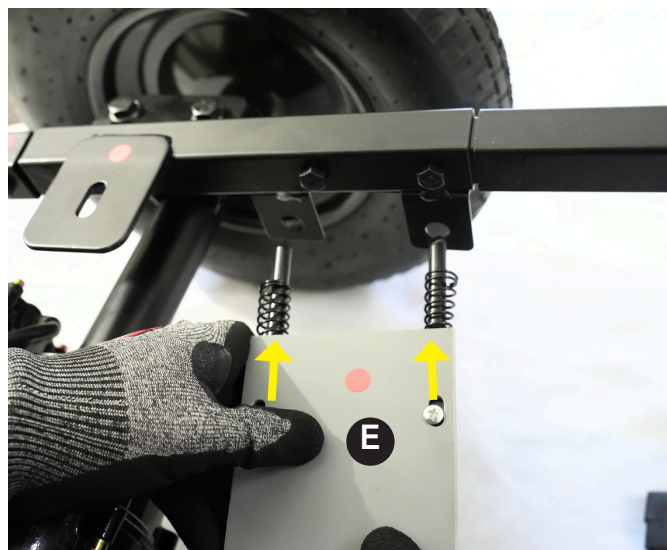

2. Push the battery box to the right to compress springs, then lift left side up and insert into left side mounts as shown and release. The box should now be suspended between the frame.

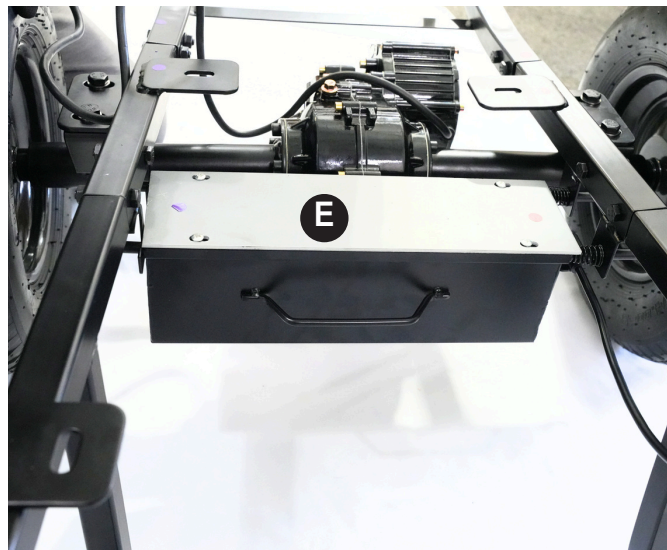
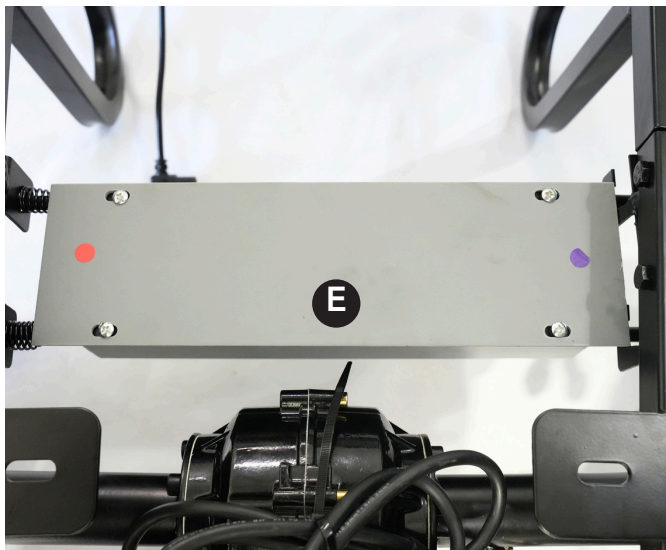

3. Insert power cord plug into outlet on the right side of the battery box. Push in to secure.

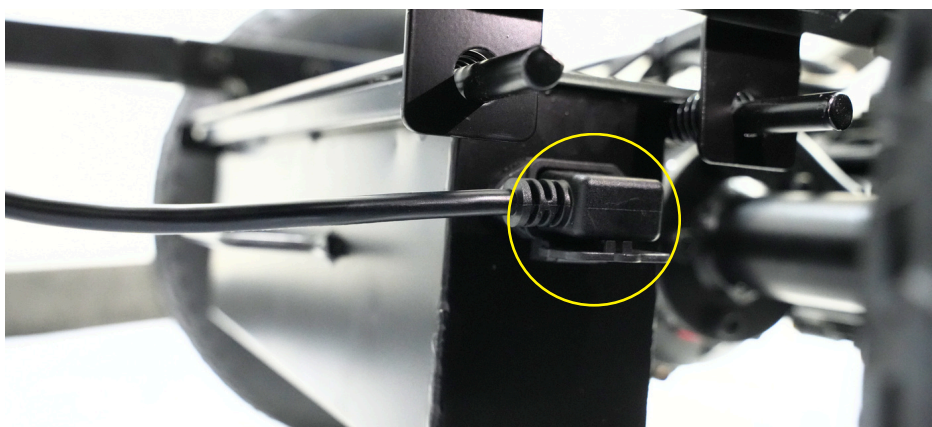

ATTACHING / ADJUSTING WIRING

1. Secure wires close to the frame using zip ties (S). Be sure to leave enough slack in the power cord so that it can be easily unplugged from the battery.

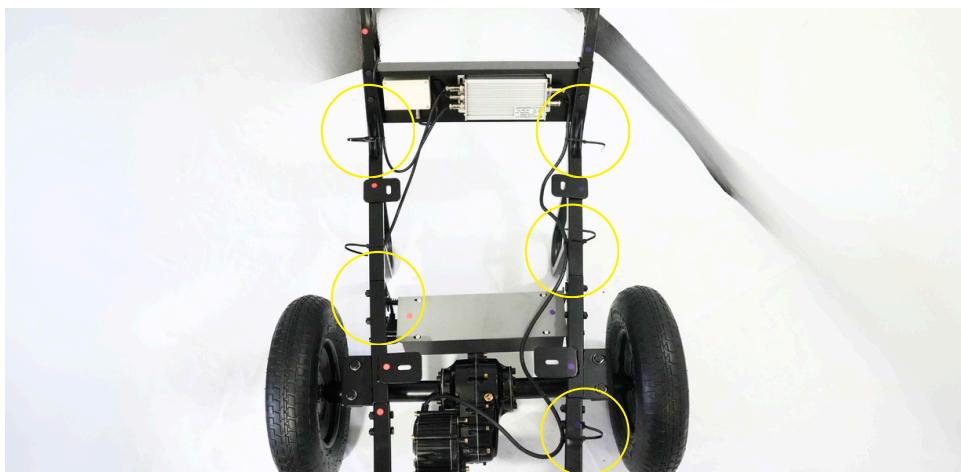
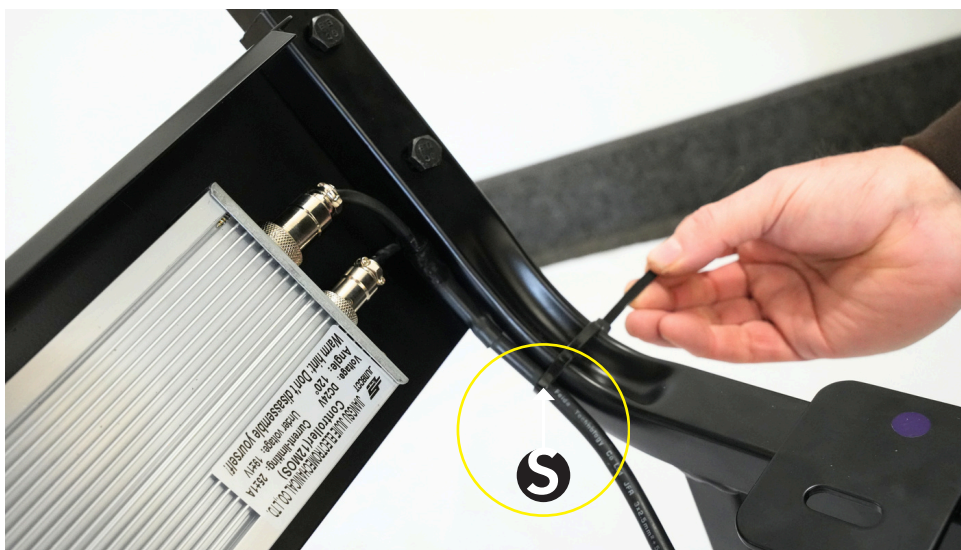
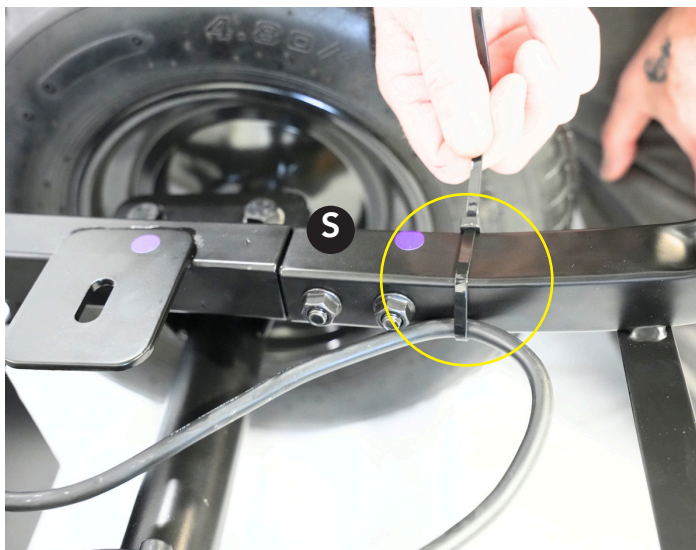

ATTACHING TRAY BRACE / ADDING OIL

1. Slide the tray brace (D) onto the dump brace extensions as shown. Use M8 x 40mm hex bolts (V) and hex nuts (T) to secure. Make sure you use the tallest setting. **NOTE: there are two heights the tray brace can be set at. Tallest setting = plastic trays. Shortest setting = non-standard tray (customer supplied).**



2. Remove oil plug bolt using a wrench and add all oil provided in squeeze bottle (X). Add slowly until bottle is empty. **NOTE: Motor will not be full. The Chore Warrior motors only need 6-8 ounces of oil.** Wipe off any excess oil with a rag. Replace bolt; turn clockwise and tighten using a wrench. Do not over-tighten.

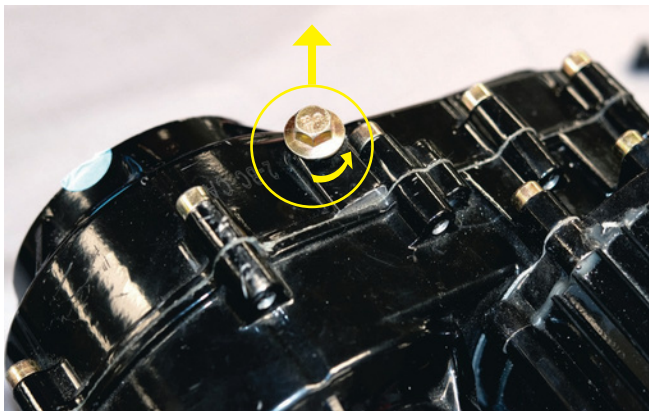

FINAL STEP BEFORE ATTACHING TRAY: TIGHTEN ALL BOLTS

Now it's time to tighten all bolts and screws with tools. Be sure they are snug, but don't over-tighten. Test the unit before mounting the tub to the frame.

ATTACHING A TRAY

1. Lower a 6 Cu. Ft. plastic tray onto the Chore Warrior frame. Line up all bolt holes in the tray with holes of the Chore Warrior frame brackets.

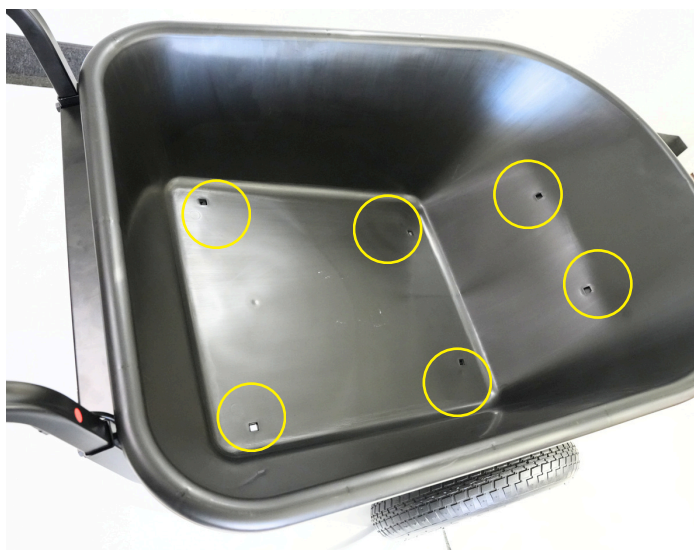

2. Insert M8 x 25mm carriage bolts (U) and provided washers through all six bolt holes of tray. These will extend through the tray brace (two) and frame (four). Secure all six bolts with M8 hex nuts (T). Tighten all nuts with tools.



CHARGING THE BATTERIES

1. Lay out battery charger (I) as shown. Vents MUST face up.

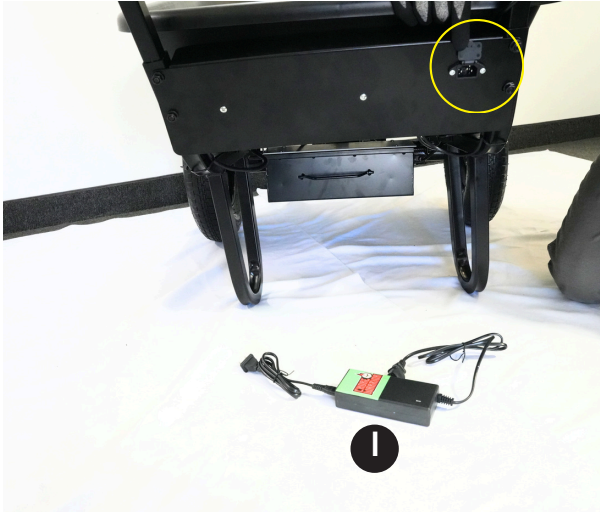

2. Remove power plug from battery box (E) located on the right side of box.



3. Insert charger plug from the battery charger (I) into the outlet on the battery box.

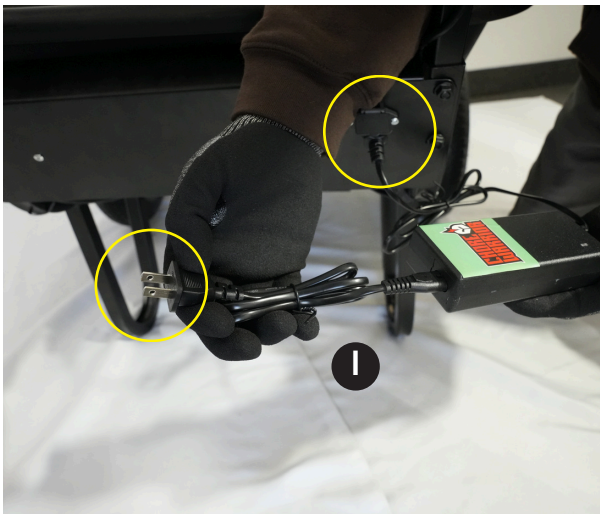

4. Insert the wall plug from the battery charger (I) into a wall outlet. A GFCI outlet is recommended.

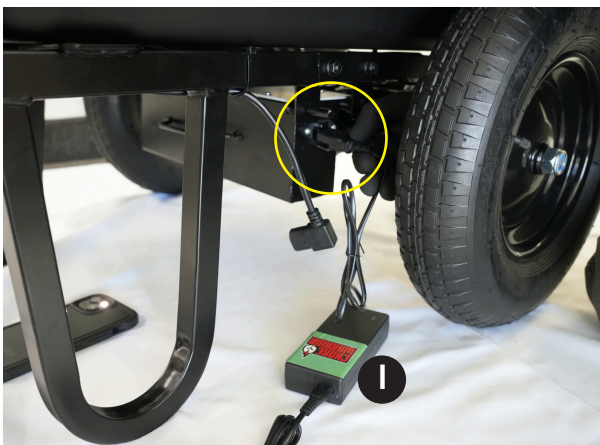

- Your Chore Warrior comes with partially charged batteries (60 to 70%) and it should operate normally once assembled. However, it is a good idea (although not necessary) to bring your batteries up to a full charge before operating. See page 3 for battery information.
- Connect the battery charger as shown. When the indicator light turns from red to green on the charger the Chore Warrior is ready for operation. The amount of time needed to fully charge the batteries will vary from ½ hour to up to 12 hours.
- Once battery is charged, unplug the charger and reinstall the power plug by reversing all previous steps on this page.
- Once you have become comfortable maneuvering the Chore Warrior with power OFF and the batteries are fully charged, it is time to turn the power ON.

⚠ CAUTION

Only charge your batteries in an open, dry, well-ventilated area. ONLY use the charger supplied with your Chore Warrior. Use of other charging systems could damage the unit and may cause harm to you.

NOTICE

- If your indicator light does not change to green within 24 hours, call us at 651-370-7508 or visit us online at chorewarrior.com.
- To purchase replacement batteries or charger contact customer service at 651-370-7508.

OPERATING YOUR CHORE WARRIOR

⚠ CAUTION

WATCH FOR HAZARDS: Using the Chore Warrior on or near steep inclines can cause your Chore Warrior to be uncontrollable and cause injury to yourself and others and/or damage to property. On steep inclines/declines, the Chore Warrior could reach an unsafe speed. Operating the Chore Warrior on steep inclines/declines can cause the Chore Warrior to tilt, tip, or possibly roll over. Another danger is loss of drive wheel traction. All of the above can cause the Chore Warrior to run out of control, resulting in possible harm and injury to yourself and/or others. It can also result in damage to your Chore Warrior and/or other property. Keep your feet firmly on the ground and two hands on the Chore Warrior handles to maintain control at all times.

BEFORE OPERATION OF YOUR CHORE WARRIOR: Your new Chore Warrior is similar to any other power driven tool. Although very easy to operate, it will take some familiarity with the controls and balance to master it fully. Before operating the Chore Warrior, it is a good idea to get familiar with controlling your Chore Warrior. Your Chore Warrior operates in much of the same way as a standard manually operated wheelbarrow – the only major difference is your Chore Warrior has an optional forward/reverse power assist. According to your physical capability, the Chore Warrior can easily be moved directionally as you desire.

MANUAL OPERATION OF YOUR CHORE WARRIOR: With power switch in the OFF (0) position take the Chore Warrior to a large open outside area. Grasp the handles with both hands, lift the Chore Warrior until the support legs are off the ground and the weight of the load is transferred to the drive wheels. In this position manually push forward, backwards, and practice turning the Chore Warrior. To dump the Chore Warrior, lift both handles in an upward forward motion, pivoting on the drive wheels and onto the dump support brace until the tub is in a vertical position.



POWER ASSIST OPERATION OF YOUR CHORE WARRIOR: Use the same care when operating the Chore Warrior in both manual and/or power assist modes.

Turn ON the power switch located on the electronics box. The battery indicator lights should illuminate on the top of the control module mounted on the right handle. (If they do not illuminate see the troubleshooting section.) Your Chore Warrior is now ready for operation. When powered on there is an internal braking system built in the motor.

CONTROLS FORWARD/REVERSE BUTTON: The forward and reverse button is located on the left (thumb) side of the right handle control module. Pushing this button will change the direction of forward or reverse. **REVERSE:** In the reverse position the Chore Warrior is designed to achieve a walk speed. This low walking speed is designed for safety reasons. Use **CAUTION** when the Chore Warrior is in reverse. Keep both hands on the handles and solid footing. **FORWARD:** The forward position has a built-in additional power boost when throttle is pushed down fully. At full throttle the Chore Warrior will move forward at a very fast walk speed. Take special care when using full throttle. Power boost is designed for use when climbing hills with the tray loaded.



OPERATING YOUR CHORE WARRIOR, CONT.

OPERATION: With the power button in the ON position, a direction selected (forward or reverse), both hands on the handles and solid footing, slowly press the thumb throttle located on the right handle. This is the variable speed/power control. The further the thumb throttle is pressed down, the more speed/power your Chore Warrior will develop. It is recommended to start at slower speeds of operation until you feel comfortable with your Chore Warrior. Once again, in power assist mode there is a dynamic braking system built into the motor.

NORMAL STOPPING YOUR CHORE WARRIOR: To stop your Chore Warrior, fully release the thumb throttle and slowly bring the Chore Warrior to a stop. Once at a stop lower the Chore Warrior onto the support legs.

FORCED STOPPING OF YOUR CHORE WARRIOR: In some situations the support legs can be used for additional slowing. While in motion release the thumb throttle and by using both handles slowly lower the Chore Warrior onto the support legs to slow the Chore Warrior to a stop. If necessary downward force can be applied to both handles for additional braking. Take care when using the support legs for stopping as too much pressure may damage your Chore Warrior or cause the Chore Warrior to become unstable. During emergency stopping, the support legs may cause damage to the stopping surface.

OPERATING TEMPERATURE RANGES: The Chore Warrior has an operational range from 110 degrees to minus 10 degrees Fahrenheit. It needs to be noted that the Chore Warrior will be affected by colder temperatures. Cold temperatures cause the Chore Warrior to become sluggish. Before operating at full capacity and at speed make sure your drive system has warmed up. For optimum performance at temperatures below 32 degrees it is recommended to keep the load under 100 lbs.

MAINTENANCE

CHARGER: Regularly examine the charger for damage to the cord, plug, housing or other parts that may result in the risk of fire, electric shock or injury. In the event of any damage, do not use the charger until the damage has been properly repaired.

TIRES: Check to make sure the lug nuts on the tires are secure. Loose lugs nuts may cause the tire to come loose and result in the loss of control. Tires are recommended to be inflated to 30 psi.

HARDWARE: Periodically check all fasteners/hardware for proper tightness. Retighten any loose hardware. It is common to retighten after several hours of use.

WIRE CONNECTIONS: Periodically check all wire connections.

TROUBLESHOOTING LOOSE WIRING / 12 VOLT BATTERY REMOVAL

REMOVE THE BATTERY BOX (E) FROM THE CHORE WARRIOR by reversing steps on page 9. Remove all four screws securing the battery box lid and remove lid.

BATTERY BOX WIRING: Loose wiring inside the battery box can cause the Chore Warrior not to operate. Take care to check that all wire connections are secure.

BATTERY REMOVAL: To remove the two 12v batteries, remove the black, red and green wire connections. Pull each of the batteries up and out of the battery box (E).

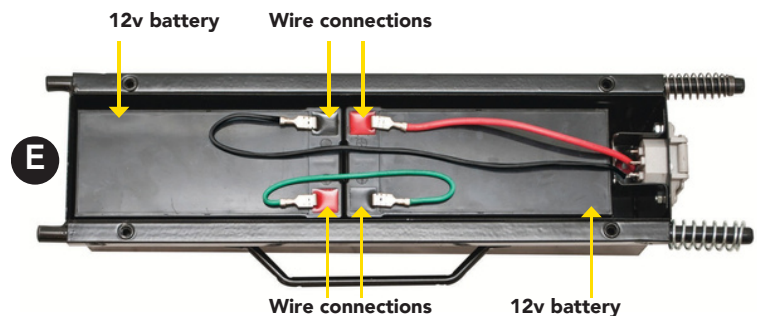

TROUBLESHOOTING, cont.

PROBLEM	POSSIBLE CAUSE	SOLUTION
CHORE WARRIOR DOES NOT RUN. CHORE WARRIOR WAS RUNNING BUT SUDDENLY STOPPED. SHORT RUN TIME (LESS THAN 1-3 HOURS PER CHARGE). CHORE WARRIOR RUNS SLUGGISHLY. BATTERY LIGHTS DO NOT ILLUMINATE.	UNDERCHARGED BATTERY	<ul style="list-style-type: none"> • Charge the battery. A new battery should have been charged for at least 12 hours before using the Chore Warrior for the first time. After first-time use, recharge the battery until the green charge light illuminates. • Check all connectors. Make sure the charger connector is plugged into the battery box, and that the charger is plugged into the wall. • Make sure power flow to the wall outlet is "ON"
	CHARGER IS NOT WORKING	There is no sure way to tell if your charger is working unless you have a volt meter. If you suspect there is a problem with your charger, contact customer service.
	LOOSE WIRE OR LOOSE CONNECTORS	Check all wires and connectors. Make sure the motor harness connector is plugged into the battery and that there are no loose wires.
	DEAD BATTERY	Charge the battery as shown on page 13.
	MOTOR DAMAGE	Contact customer service for diagnosis and/or repair.
	OVERCHARGED BATTERY	Do not charge the battery longer than 24 hours. If you suspect damage due to overcharging, contact customer service.
	CHORE WARRIOR IS OVERLOADED AND/OR RUNNING CONDITIONS ARE TOO STRESSFUL	Make sure not to overload the Chore Warrior. Maximum capacity is 350 lbs. Run in a less stressful environment.
SOMETIMES THE CHORE WARRIOR DOES NOT RUN.	LOOSE WIRE OR CONNECTOR	Check all wire connections to make sure they are tight.
	MOTOR OR ELECTRICAL DAMAGE	Contact customer service for diagnosis and repair.
BATTERY MAKES A SIZZLING OR GURGLING NOISE WHEN CHARGING	IT IS NORMAL FOR THE BATTERIES TO MAKE NOISE OR SWELL SLIGHTLY WHILE CHARGING AND IS NOT REASON FOR CONCERN.	No action required. If your battery does not make noise or swell slightly during charging, it does not mean that it is not accepting the charge.
ONE OR MORE TIRES ARE FLAT	TIRE HAS LOST AIR	Inflate the tire with air to 30 psi.
	TIRE PUNCTURE	Patch or replace damaged inner tube.
	LEAKY TIRE AIR VALVE	Replace or tighten tire air valve.
CHORE WARRIOR FEELS LOOSE OR LESS SOLID THAN INITIAL ASSEMBLY	CHORE WARRIOR HARDWARE HAS BECOME LOOSE	Retighten all hardware with wrench.

Customer service: 651-370-7508
Monday – Friday 8am – 5pm CST

WARRANTY / PRODUCT REGISTRATION

LIMITED WARRANTY AND LIMITATION OF LIABILITY

Power Assist Technologies warrants this product, to the original purchaser, for the initial residence in which it is located (upon verification that it is assembled correctly) to be free from defects in materials and or workmanship for a period of 1 YEAR from the date of purchase, with the exception that certain components which wear out upon normal use are excluded from this warranty. Examples of such components include but are not limited to; tires, rims and transmission. As the sole and exclusive remedy for a breach of this limited warranty, if the product is found to be defective by Power Assist Technologies, Power Assist Technologies, at its option, will repair the product or replace it with an equivalent product. If this product should fail during the limited warranty period **call 651-370-7508 toll free to file a Warranty claim**. If the product is deemed by Power Assist Technologies to contain a manufacturer's defect covered by this limited warranty and if it is determined it cannot be fixed at the original location,

Call 651-370-7508 for a RGA# and then send product post paid to:

Power Assist Technologies

ATTN: Warranty Dept.

926 Dale St N

St. Paul, MN 55103

Please include a brief description of the problem and a dated proof-of-purchase receipt with any product returned for warranty repair. Defective product will be repaired or replaced with new or factory-rebuilt parts at manufacturer's sole option. Any costs unrelated to a manufacturer's defect are not covered by this Limited Warranty. As the owner of the product, you are solely responsible for any such unrelated costs which may be incurred.

In order to ACTIVATE YOUR WARRANTY, the original purchaser must register the product using the form below or online at chorewarrior.com within 30 days of purchase. A copy of the original receipt must accompany the warranty registration.

- ANY ABUSE, MODIFICATION OR DISASSEMBLY OF THIS PRODUCT VOIDS THIS LIMITED WARRANTY.
- POWER ASSIST TECHNOLOGIES DISCLAIMS ALL OTHER EXPRESS OR IMPLIED WARRANTIES INCLUDING WARRANTIES OF MERCHANTABILITY OR FITNESS FOR A PARTICULAR PURPOSE.
- POWER ASSIST TECHNOLOGIES SHALL NOT BE LIABLE FOR CONSEQUENTIAL OR INCIDENTAL DAMAGES THAT ARISE IN CONNECTION WITH USE, OR INABILITY TO USE THIS PRODUCT.

This warranty shall not apply to damage due to acts of God, normal wear and tear, normal maintenance services and the parts used in connection with such service, lightning, or have been subject to negligence, abuse, accident, misapplication, tampering, alteration; nor due to improper installation, operation, maintenance, or storage; nor to excess of recommended maximums as set forth in the instructions, or conditions beyond the control of Power Assist Technologies.

Any oral statements about the product made by the seller, Power Assist Technologies, the representatives, or any other parties do not constitute warranties, shall not be relied upon by the user, and are not part of the contract for sale. Sellers' and Power Assist Technologies' only obligation and the buyer's only remedy, shall be the replacement and/or repair by Power Assist Technologies of the product as described above. Neither seller nor Power Assist Technologies shall be liable for any injury, loss or damage, direct or indirect damages, incidental or consequential damages, (including but not limited to incidental or consequential damages for lost profits, lost sales, injury to person or property,) or any other incidental or consequential loss arising out of or related to the use or the inability to use the product, and the user agrees that no other remedy shall be available to it. Before using the product the user shall determine the suitability of the product for his/her intended use and user assumes all risk and liability whatsoever in connection therewith.

The warranty and remedy in this limited warranty is an exclusive warranty and remedy and is in lieu of any other warranty or remedy, expressed or implied, which other warranties and remedies are hereby expressly excluded, including but not limited to any implied warranty of merchantability or fitness for a particular purpose. To the extent either applies to a product it shall be limited in duration to the periods of the expressed limited warranties given above. Some states do not allow the exclusion or limitation of consequential or incidental damages, so the above limitation or exclusion may not

apply to you. This limited warranty gives you specific legal rights, and you may also have other rights which vary from state to state.

REGISTRATION CARD

CUSTOMER FIRST NAME: _____

CUSTOMER LAST NAME: _____

CUSTOMER ADDRESS: _____

CITY: _____ **STATE:** _____

ZIP: _____

PHONE NUMBER: _____

EMAIL: _____

ZIP: _____

MODEL NUMBER: _____

PLACE OF PURCHASE: _____

DATE OF PURCHASE: _____

COMMERCIAL APPLICATION: YES NO

DID PURCHASER ASSEMBLE THE PRODUCT: YES NO

If no, who installed the product: _____

Cut along dotted line and mail card to:

Power Assist Technologies
ATTN: Warranty Dept.
926 Dale St N
St. Paul, MN 55103

OR register online at chorewarrior.com.



Customer service: 1-651-370-7508
Monday – Friday 8am – 5pm CST

www.chorewarrior.com

Power Assist Technologies
926 Dale St N
St. Paul, MN 55103